

Community Open Houses

On Future of Library Building
May 20-21, 2018

Current Problems that are getting worse!

Which of these problems do you think are most critical? Choose 3!

LITTLE QUIET READING AND STUDY SPACE

- Minimal comfortable seating areas for quiet reading
- No private consultation areas for staff and patrons

MEETING SPACE - LARGE

- Library use of current room often blocked by previous booking
- Demand for public use of meeting room exceeds schedule capacity
- No space for community events with large attendance

MEETING SPACE - SMALL

- No small study rooms
- No space for small group meetings
- No separate areas for noisy collaboration

COLLECTIONS

- No space for book collection to grow
- Not enough space for children's and teens' collections
- Not enough space for audiobooks, DVDs, special collections
- No space to add new collections

CHILDREN'S AND TEEN FACILITIES AND SERVICES

- Children's and teen areas too far apart for good supervision
- Children's and teen areas too close to work and study areas creating noise issues
- No direct outside access to/from children's area
- Inadequate space at Library for summer reading and other heavily attended programs

PARKING

- Inadequate, difficult to access parking spaces
- Drive narrow and congested
- Unsafe as accidents occur regularly
- Inadequate security lighting to illuminate all areas

OUTDOOR GATHERING SPACE

- No space for outdoor children's and other programming
- No outdoor seating
- No green space

ENTRANCE AMENITIES

- No covered areas for public seating or staff access to book drop
- No safe book drop access out of traffic flow
- No safe passenger drop-off area

BUILDING ISSUES

- Floor space use at maximum
- No flexible spaces and furniture for multi-purpose use
- Inadequate copy/print equipment and work space
- Inadequate space for expanding user work spaces and technology
- On-going basement and parking area flooding and drainage issues
- Restrooms difficult for ADA access

SUPPORT SERVICES

- Inadequate workspace for staff to facilitate public services
- No staff breakroom, inadequate storage, no secure access
- No loading dock for deliveries

"If the Library had more space, I would recommend it be used for..."

Choose up to five:

... collection growth (books, audiobooks, large print, etc.)

... expansion of children's and teen areas and collections

... relocating children's and teen areas away from adult work and reading spaces

... program and meeting space for larger gatherings

... small meeting and study spaces

... more quiet, comfortable reading spots

... private study carrels and work spaces with technology connectors

... a dedicated maker-space for 3-D printing, crafts, activities

... more computer space and work tables with technology connectors

... expanding parking area, improving driveway safety, improving bike rack area

... improving pedestrian and driver comfort and safety

... outdoor green space, seating, programming areas

... improving efficiency and cost-saving operation of building infrastructure

... more display space for art, cultural objects, community information

... space for and acquiring a generator to allow the Library to become an emergency warming and cooling center for the community

Planning Options

Which of these options would you support?

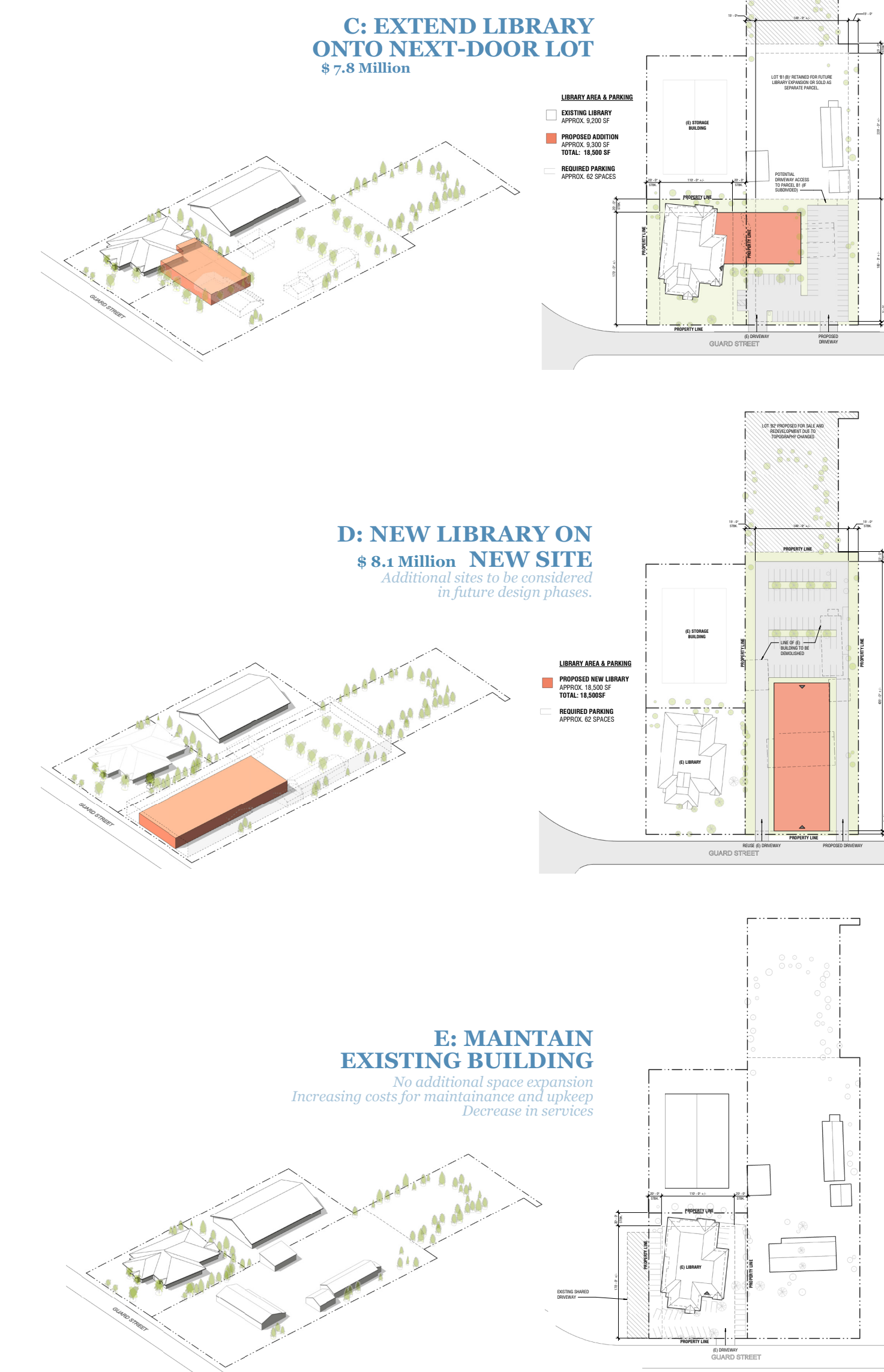

Images from Public meetings. May 20th and 21st, 2018



| | Votes 1st Session | Votes 2nd Session | Votes 3rd Session | Votes All Sessions |
|--|-------------------|-------------------|-------------------|--------------------|
| Number of Attendees | 30 | 25 | 30 | 85 |
| Current problems that are getting worse (choose 3) | | | | |
| Little quiet reading and study space | 1 | 0 | 5 | 6 (3.5%) |
| Meeting space - Large | 16 | 5 | 11 | 32 (17.5%) |
| Meeting space - Small | 5 | 2 | 5 | 12 (6.5%) |
| Collections | 17 | 7 | 6 | 30 (16.5%) |
| Children's and teen facilities and services | 2 | 7 | 9 | 18 (10%) |
| Parking | 14 | 6 | 15 | 35 (19%) |
| Outdoor gathering space | 0 | 0 | 7 | 7 (4%) |
| Entrance amenities | 0 | 1 | 2 | 3 (2%) |
| Building issues | 8 | 8 | 7 | 23 (13%) |
| Support services | 8 | 3 | 3 | 14 (8%) |
| If the library had more space, I would recommend it be used for... (choose up to 5) | | | | |
| ... Collection growth (books, audiobooks, large print, etc.) | 21 | 10 | 7 | 38 (14%) |
| ... Expansion of children's and teen areas and collections | 4 | 8 | 6 | 18 (6.5%) |
| ... Relocating children's and teen areas away from adult work and reading spaces | 6 | 3 | 11 | 20 (7%) |
| ... Program and meeting space for larger gatherings | 16 | 8 | 14 | 38 (14%) |
| ... Small meeting and study spaces | 6 | 3 | 4 | 13 (4.5%) |
| ... More quiet, comfortable reading spots | 8 | 1 | 8 | 17 (6%) |
| ... Private study carrels and work spaces with technology connectors | 4 | 0 | 2 | 6 (2%) |
| ... A dedicated maker-space for 3-D printing, crafts, activities | 2 | 1 | 1 | 4 (1.5%) |
| ... More computer space and work tables with technology connectors | 6 | 4 | 9 | 19 (7%) |
| ... Expanding parking area, improving driveway safety, improving bike rack area | 13 | 8 | 11 | 32 (11.5%) |
| ... Improving pedestrian and driver comfort and safety | 1 | 2 | 8 | 11 (4%) |
| ... Outdoor green space, seating, programming areas | 6 | 1 | 8 | 15 (5.5%) |
| ... Improving efficiency and cost-saving operation of building infrastructure | 8 | 4 | 7 | 19 (7%) |
| ... More display space for art, cultural objects, community information | 4 | 3 | 4 | 11 (4%) |
| ... Space for and acquiring a generator to allow the Library to become an emergency warming and cooling center for the community | 5 | 4 | 6 | 15 (5.5%) |
| Planning Options: Which of these options would you support? | | | | |
| C: Extend Library onto next-door lot | 6 | 1 | 4 | 11 (18.3%) |
| D: New Library on new site | 17 | 13 | 19 | 49 (81.7%) |
| E: Maintain existing building | 0 | 0 | 0 | 0 (0%) |

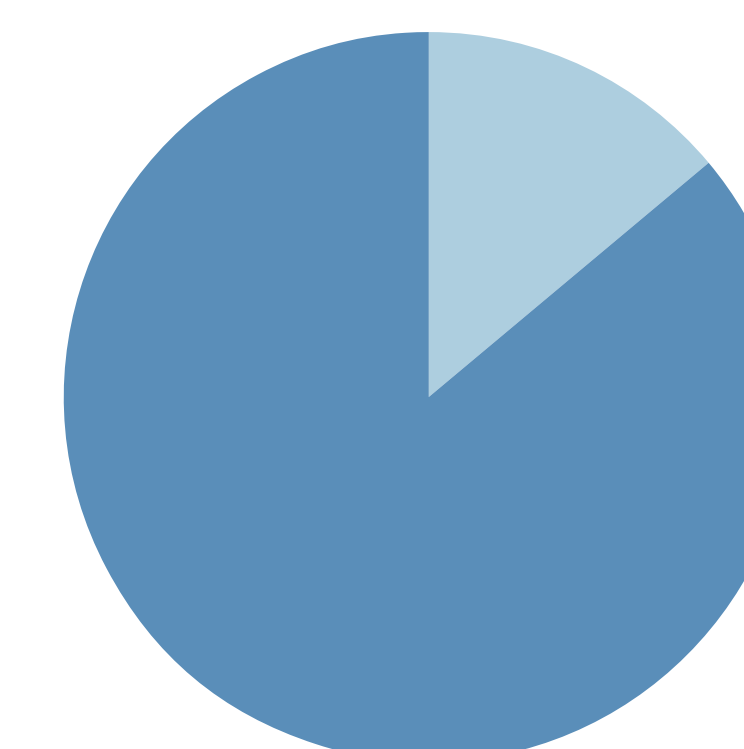

PLANNING OPTIONS: WHICH OF THESE OPTIONS WOULD YOU SUPPORT?

- C: Extend Library onto next-door lot
- D: New Library on new site
- E: Maintain existing building